

Universal cylinders - Single acting *Application & selection*

Shown: RW-50, BRW-104



Used when high cylinder forces or long strokes are required in a confined area. Can handle a wide range of production tooling applications.

Block and cylindrical models

Cylindrical models

- Long stroke
- Flexible in fixture design
- Variety of attachments

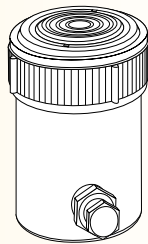

Block models

- Easily mounted
- Compact design

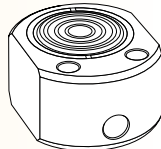

ENERPAC RW-101 cylinders used in a high pressure toggle style clamping set-up.



Heavy-duty cylinders

...handle a variety of applications

- High pressure design when additional force is required
- Long stroke lengths in a compact design, well suited for welding applications
- Collar mounting threads and base mounting holes allow flexible mounting options
- Cylinders are provided with hardened saddles for additional plunger protection
- Snap-in saddles are easily removed for adapting to different plunger devices
- Chrome plated plunger with bronze upper and lower bearing provides a long cylinder life.

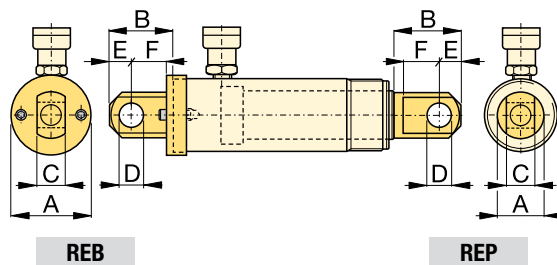

Type	Model number	Clevis eye dimensions (mm)						Pin to pin* mm
		A	B	C	D	E	F	
Base ¹⁾	REB-5	44,5	47,8	14,2	16,0	16,0	25,4	60,2
	REB-10	63,5	66,8	25,4	22,3	25,4	35,1	78,0
Plunger	REP-5	28,7	41,2	14,2	16,0	16,0	19,1	—
	REP-10	42,9	50,8	25,4	22,3	25,4	28,7	—

* Pin to Pin— REB and REP Clevises fitted. Add cylinder stroke length.

¹⁾ Mounting screws are included.

Product selection

Cylinder capacity at 350 bar	Stroke	Model number	Effective area	Oil capacity	Operating pressure
kN	mm		cm ²	cm ³	bar
▼ Block models					
22,1	15,7	RW-41	6,39	10,16	6-550
22,1	15,7	RW-50	6,39	10,16	40-700
22,1	15,0	MRW-50F	6,39	10,16	6-550
22,1	15,0	MRW-50M	6,39	10,16	6-550
▼ Cylindrical models					
22,1	25,7	BRW-51	6,39	16,22	40-700
22,1	80,5	BRW-53	6,39	48,67	40-700
22,1	131,3	BRW-55	6,39	81,12	40-700
50,6	25,1	BRW-101	14,39	36,54	40-700
50,6	55,4	BRW-102	14,39	77,84	40-700
50,6	106,2	BRW-104	14,39	150,92	40-700
50,6	155,2	BRW-106	14,39	224,01	40-700
50,6	257,3	BRW-1010	14,39	370,18	40-700

Note: Seal material Buna-N, Polyurethan.

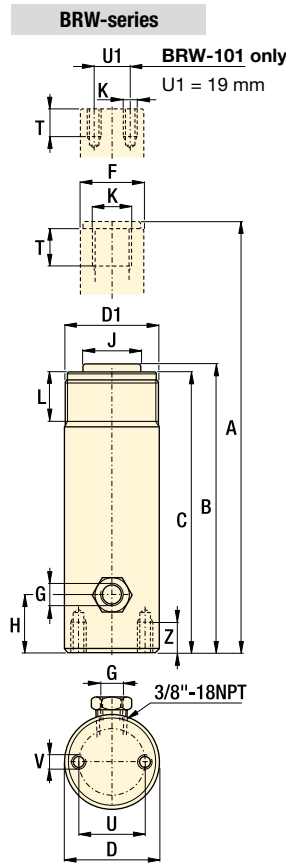
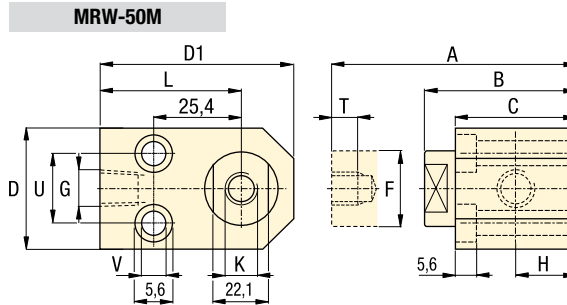
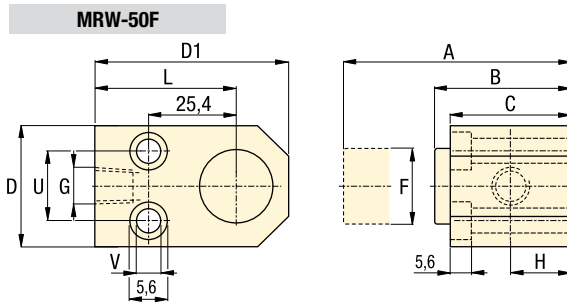
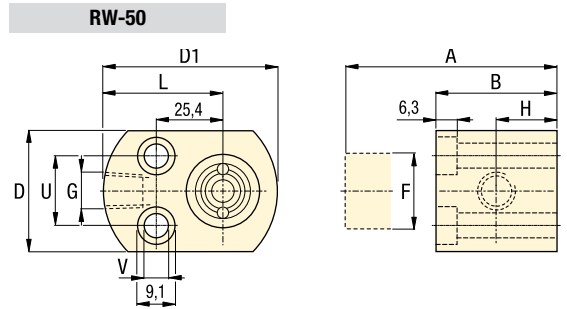
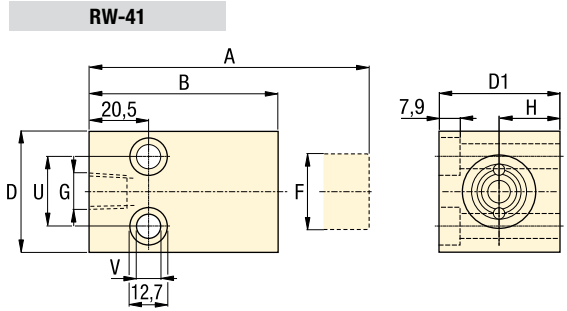

Force: 22,1 - 50,6 kN

Stroke: 15,0 - 257,3 mm

Pressure: 40 - 350 bar

- E** Cilindros universales
- F** Vérins universels
- D** Universelle Linearzylinder



Options

Cylinder accessories

86 ▶

Important

These cylinders are intended for medium cycle applications. The return spring is intended for retracting the plunger is intended for heavy devices should not be attached to it.

Plungers should be shielded in welding applications to prevent splatter from sticking to chrome plating.

Do not use these cylinders continuously at full stroke or damage to return spring may result.

Product dimensions in mm []

Model number	A	B	C	D	D1	F	G	H	J	K	L	T	U	V	Z	kg
							NPTF									
▼ Block models																
RW-41	80,8	65,0	-	41,1	41,1	25,4	1/4 -18	20,6	-	-	-	-	25,4	8,9	-	0,8
RW-50	56,9	41,4	-	41,1	58,9	25,4	3/8 -18	19,1	-	-	38,1	-	28,4	5,6	-	0,8
MRW-50F	55,9	40,9	40,9	41,1	65,0	25,4	3/8 -18	20,6	-	-	44,5	-	28,4	5,6	-	0,8
MRW-50M	66,0	51,1	40,9	41,1	65,0	25,4	3/8 -18	20,6	-	M8 x 1,25	44,5	6,1	28,4	5,6	-	0,8
▼ Cylindrical models																
BRW-51	137,7	112,0	103,9	38,1	M38 x 1,5	25,4	1/4 -18	19,1	25,4	M18 x 2,5	30,0	15,5	25,4	M6 x 1	14,0	1,0
BRW-53	247,1	166,6	158,8	38,1	M38 x 1,5	25,4	1/4 -18	19,1	25,4	M18 x 2,5	30,0	15,5	25,4	M6 x 1	14,0	1,4
BRW-55	349,0	217,7	209,6	38,1	M38 x 1,5	25,4	1/4 -18	19,1	25,4	M18 x 2,5	30,0	15,5	25,4	M6 x 1	14,0	1,8
BRW-101	115,1	89,9	86,6	57,2	M56 x 2	38,1	1/4 -18	19,1	-	M5 x 0,8	29,2	6,1	39,6	M8 x 1,25	12,4	1,7
BRW-102	177,0	121,7	115,1	57,2	M56 x 2	38,1	1/4 -18	19,1	35,1	M22 x 1,5	29,2	17,3	39,6	M8 x 1,25	12,4	2,2
BRW-104	278,6	172,5	165,9	57,2	M56 x 2	38,1	1/4 -18	19,1	35,1	M22 x 1,5	29,2	17,3	39,6	M8 x 1,25	12,4	3,2
BRW-106	401,8	246,6	241,3	57,2	M56 x 2	38,1	1/4 -18	19,1	35,1	M22 x 1,5	29,2	17,3	39,6	M8 x 1,25	12,4	4,4
BRW-1010	606,6	349,3	342,9	57,2	M56 x 2	38,1	1/4 -18	19,1	35,1	M22 x 1,5	28,7	19,1	39,6	M8 x 1,25	12,7	6,3